



e-TX REMOTE VERSION 4

Specifications

Frequency:	433.39 MHz
Security:	128-bit AES Encryption
Radio Range:	Up to 50 Metres
Battery life:	Up to 3 Years
Battery type:	1 x CR2032 Lithium Battery

NOTE: The first e-TX Remote button coded into a transceiver will set that button number as the *only* button able to activate that transceiver/channel. To change button allocation for *all* remotes; take a **coded** remote and whilst pressing and holding **CODE** and pressing the new button allocation of choice.

Switching from V3 to V4

To set e-TX Operational version back to Version 3. Press & Hold Buttons, 1 + 3 for 5 seconds. The Blue LED will flash 3 times to indicate Version 3.



Switching from V4 to V3

To set e-TX Operational version back to Version 4. Press & Hold Buttons, 1 + 4 for 5 seconds. The Blue LED will flash 4 times to indicate Version 3.



e-Trans 200



Coding Remote

- To enter **CODE LEARN** rotate dial clockwise to **CODE DEVICE** then press **PB (Push Button)**. **CODE LEARN** will display and green LED will flash indicating coding sequence.

Screen Display in operational mode



- Press remote button once > display will show **ACCEPT REM 1**, then screen will display **CONFIRM REM 1**. Press remote button again and screen will display **REM 1 CODED**. You can then follow on with a second remote in which **ACCEPT REM 2** will display. If no further remote buttons are pressed, **CODE DEVICE** will exit back to main screen after 5 seconds.



NOTE: First coded remote button selection will set the button allocation for all following remotes. Within Coded Devices sub-menu, under Allocate Button Press **PB** to enter selection, rotate dial to change button number, press dial to confirm and move to **RELAY 2 / BUTTON 2**.

e-Trans 20 e-Trans 50 e-Trans 100

Coding Remote

- To code device press and release **CODE** button. The blue LED will illuminate
- To code **e-TX Remote**, press and release the remote button that you want to activate transceiver once (1 - 4). The **CODE** LED will flash, indicating the remote has been coded successfully. Now either continue with coding another remote, or press your chosen remote button again to exit **CODE** learn. You can also exit **CODE** Learn by waiting 5 - 10 seconds.

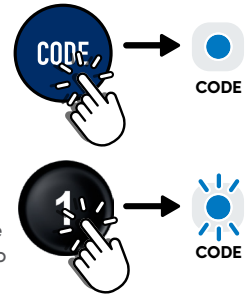

e-Trans 20 e-Trans 50

Deleting Remotes

- Press and hold **CODE** button for 10 seconds. All LEDs will flash 3 times to indicate all remote devices have been cleared.



e-Trans 100

Deleting all Coded Devices

- To delete all devices, press and hold the **CODE** channel button you wish to delete. After 10 seconds you should see all channel 1 LEDs flash twice for channel 1, or all channel 2 LEDs flash twice for channel 2.

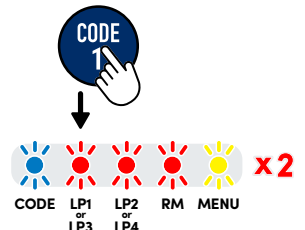

Deleting all Remotes

- Press and hold the **CODE** channel button, now press and release the **MENU** button and 'LP1/3' LED will light up. If this is not correct, then press and release the **MENU** button again until you are on the correct LED.
- Once the correct selection has been made, keep your finger on the **CODE** button until all LEDs on channel flash.

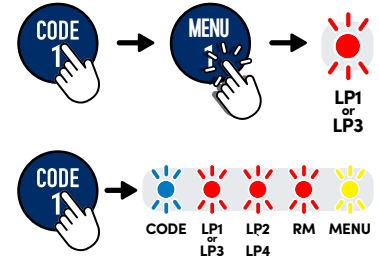

e-Trans 200



Deleting Remotes

To delete remotes, rotate dial clockwise to **MAIN MENU** then press **PB (Push Button)**. Then navigate to **DELETE DEVICE**. From here select either: **DELETE ALL** or **DELETE REMOTE**. **DELETE ALL**: Removes All Devices. **DELETE REMOTE**: You can select either specific devices to remove, or delete all coded remotes.

